

2" BORE STAINLESS STEEL CYLINDER



SDD-32-□-□

Double Acting

Mount: Stud **Standard Stroke Lengths:** 1", 2", 3", 4", 5", 6", 8", 10", 12"
Type: Double Rod **Maximum Stroke:** 18"
Options: C, F, M, B, W, V, P6, P7, P8, N

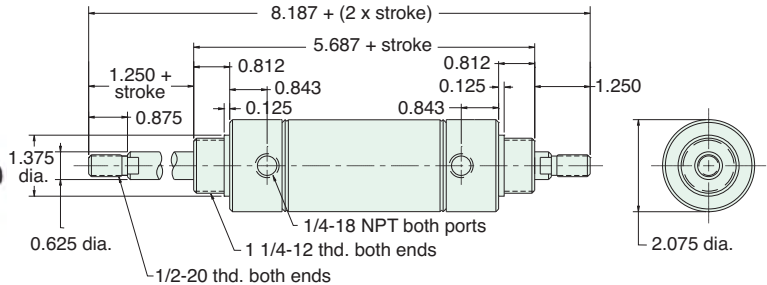

Nuts included, but not shown on drawing

SRR-32-□-□

Reverse Acting

Mount: Stud **Standard Stroke Lengths:** 1", 2", 3", 4", 5", 6"
Type: Rotating Rod **Spring Compressed:** 30 lbs. **Spring At Rest:** 15 lbs.
Options: M, B, W, V, N **Maximum Stroke:** 12" For M option add 0.125

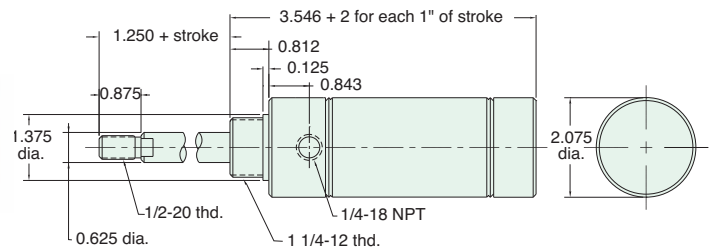

Nut included, but not shown on drawing

URR-32-□-□

Reverse Acting

Mount: Universal **Standard Stroke Lengths:** 1/2", 1", 1-1/2", 2", 3", 4"
Type: Rotating Rod **Spring Compressed:** 30 lbs. **Spring At Rest:** 15 lbs.
Options: M, B, W, V, P2, N **Maximum Stroke:** 13" For M option add 0.125

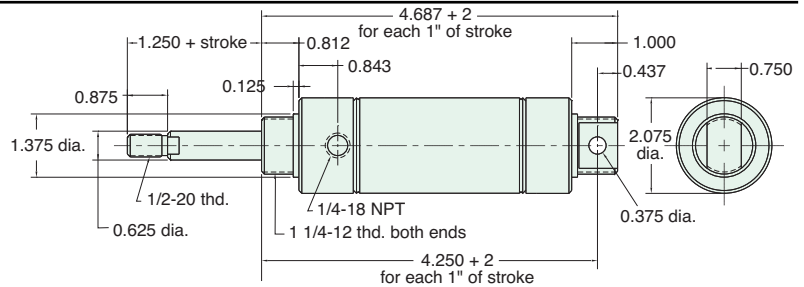

Furnished without nut(s). See Chart on Page 57.

SFR-32-□-□

Spring Bias

Mount: Stud **Standard Stroke Lengths:** 1/2", 1", 1-1/2", 2", 3", 4"
Type: Rotating Rod **Spring Compressed:** 30 lbs. **Spring At Rest:** 15 lbs.
Options: M, B, W, V, P6, P7, P8, S, N For S option add 0.375

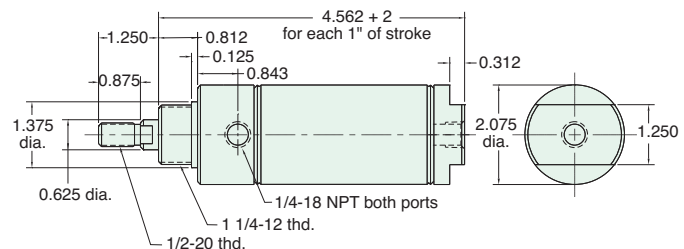

Nut included, but not shown on drawing